



Boston Public Schools

**BuildBPS Update for the  
Blackstone School Community**

December 8, 2021

---

Nathan Kuder, Chief Financial Officer

# Solution for SY22-23 K-6 Expansion at the Blackstone

In response to community feedback provided to the BuildBPS proposal for SY22-23 K-6 expansions, the district revisited the initial plan, which originally proposed a delay in adding sixth grade to the Blackstone due to physical space limitations.

Each school site received an interior and exterior site assessment, as well as discussions with community partners willing to provide short term space solutions. The district was able to identify short term solutions for the Blackstone to support expanding to K-6 in SY22-23.

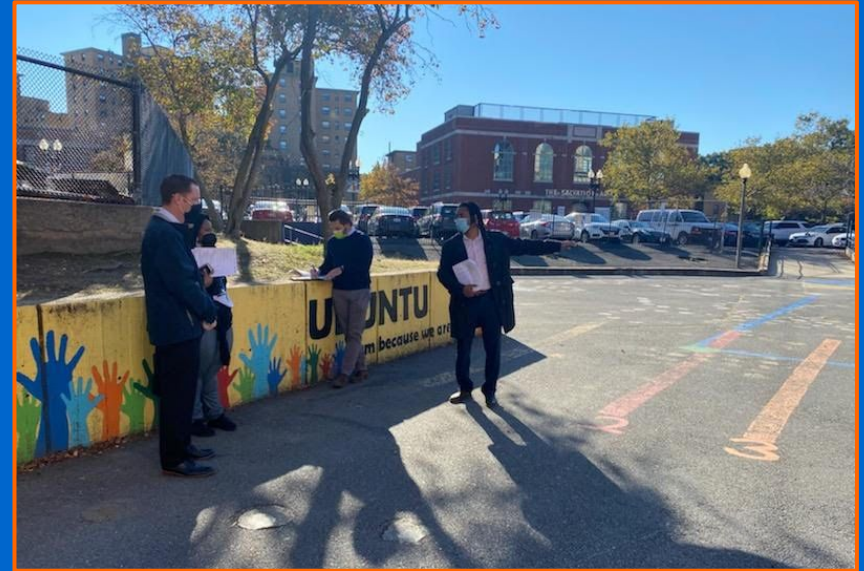

# Blackstone School K-6 Expansion:

## Site Assessment Options Considered

### OPTION 1:

Outdoor School Site Options Vetted  
*(i.e. modular on campus)*

RESULT: The outdoor space in front of the parking lot was assessed, but would severely limit student outdoor play space and does not satisfy the space needs for a modular.

*A modular does not appropriately fit and therefore is not an option.*

### OPTION 2:

Interior School Site Options Vetted  
*(i.e. repurposing spaces within the school building)*

RESULT:

- The cafeteria was assessed but this would require students to eat lunch in classrooms.
- Additional space behind the cafeteria was identified which equates to 2 classes worth of space, the space would need further modifications and would impact indoor recess and lunch schedules/programming.
- The school currently uses some full-sized classrooms for non-core instruction. These classrooms could potentially be used for grade 6 classrooms if alternative spaces for the current use can be identified.

*Ultimately, there are potentially two or three interior spaces that could be converted to classrooms, but it still does not meet the total 4-6 classrooms needed.*

# Blackstone School K-6 Expansion

## Site Assessment Details (Continued)

### OPTION 3:

Non-School Site Options  
*(i.e. space usage in partnership  
with local community organization)*

- Blackstone Community Health Center was originally under consideration for space, however the current lease does not end until November 2022, and it currently houses a non-profit organization that is critical to the community - displacing the organization could be a hindrance to the community.
- Blackstone BCYF has 3 potential classroom spaces including a computer lab, 2 rooms in the teen center, and community rooms. There is also a fitness room that was ruled out by facilities.
- Salvation Army was also reached out to, but they did not have the space we would need for additional classrooms

*Ultimately, there is space at BCYF that can be used for  
2 to 3 classroom spaces*

# Blackstone School K-6 Expansion | Short Term Space Solutions

## Decision for Next School Year

- 2-3 classroom spaces in the Blackstone BCYF
- 2-3 classrooms spaces from repurposing current space within the school building.

## Immediate Next Steps

- We will work with BCYF throughout December and January to determine:
  - Programming needs from school and community center perspective and how both communities will coincide in community center space
  - Staffing needs to support adding a 6th grade
  - School Schedules being mindful that extra space that is more spread out may require creative scheduling
  - Physical space configuration and needs
  - Finalize which grades and/or programing will be placed in the expansion space
- Repurposing some internal space is possible. We will work with the school leader and staff to do a further assessment of the internal spaces to determine which spaces are most appropriate to repurpose while also prioritizing maintaining the same level of services to students

*The BuildBPS Team plans to return to the Blackstone School Community with further updates on the plan in February 2022*

# Q&A | Community Discussion



# Appendix



# K-6 Pathway Framework

Our objective is to map out the [path to K-6 for most elementary schools](#) over the next several years. For our assessment, we used four areas of impact for prioritization:

Impacted by school closures

Addressing schools impacted by school closure is our first priority in order to re-configure enrollment capacity.

Current building capacity for expansion

Assessing which schools have space in their current building to go K-6 with no or minor changes to programming and/or the facility

Current expandable lot capacity

Exploring whether there is room to add a modular as a temporary solution

Path to permanent solution

Where temporary or less than ideal solutions are required, we also consider the path to more sustainable solutions, including repurposing existing school buildings



# Proposed K-6 Pathway for SY22-23 Flowchart

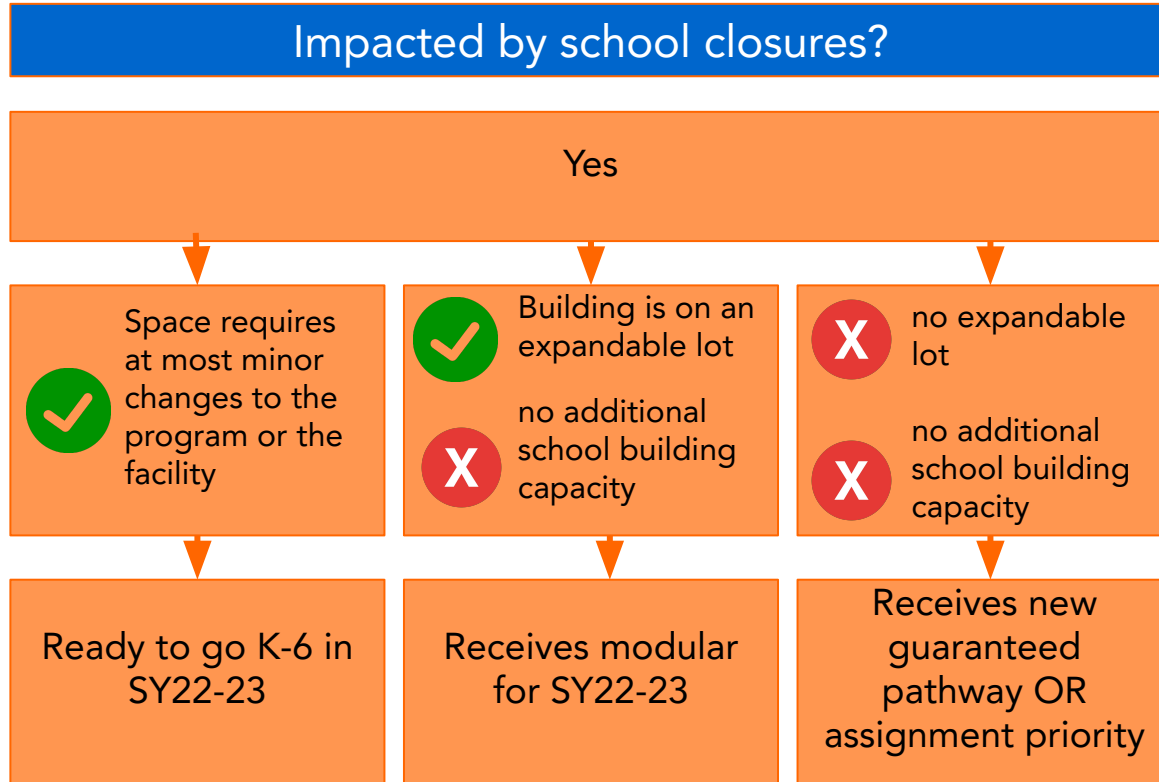

# Facilities Exterior Site Assessment Criteria Rubric

Exterior Assessment Criteria		Description
1	Space	<p><b>Dimensions:</b> what is the estimated size of the location in feet (length x width)</p> <p><b>Building Size:</b> does the site have a rectangular site large enough to fit a modular with the required number of classrooms?</p> <p><b>ADA Compliance:</b> 4.5' of clearance on all sides of the building for students and faculty in a wheelchair? is there enough room for an ADA ramp for all exits?</p>
2	Site	<p><b>Fire safety plan:</b> Does the placement of a modular on this location impede the safe exit for either the main or modular building in case of emergency.</p> <p><b>Set up:</b> Ability to ensure appropriate power, lighting, ventilation, and windows to modular.</p>
3	Logistics	<p><b>Hoistway:</b> Is there appropriate space and overhead clearance established for bringing in the unit?</p> <p><b>Ground:</b> is the ground sufficiently level and appropriate for a modular set up?</p> <p><b>Delivery/Removal:</b> is there access for the modular and construction supplies in and out?</p>
4	Trade-Offs	<p><b>Current use</b> of the space and the school leader's response to the disruption of that use.</p> <p><b>Future Use:</b> Are there any planned projects for this space?</p>

# Blackstone Building Assessment Findings - Conducted November 3, 2021

## Summary of Space Needs:

- Estimated number of classrooms: 4-6
- Estimate square footage of modular (building only): 48' x 60'

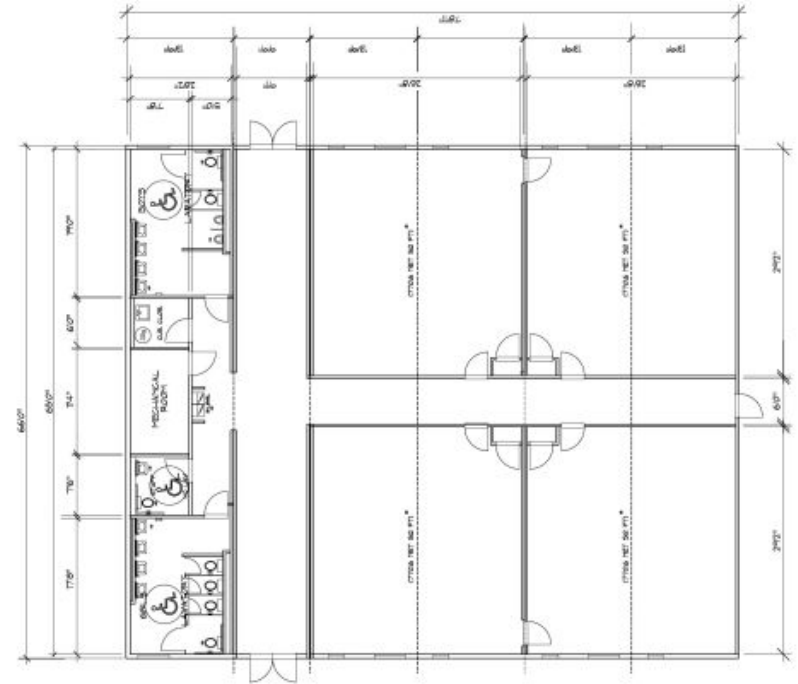

Example floor plan of a standard 4 classroom modular with restrooms